

Shaw Theatre

NAIT South Learning Centre | Room: X123

The NAIT Shaw Theatre is our largest venue, boasting state-of-the-art lighting, video and audio capabilities. Our theatre has a large lobby that can be used for cocktail receptions or food service. The theatre-sized screen and podium make it a perfect venue for conferences, presentations and award ceremonies.



Capacity:

372 people in tiered theatre seating

Audio Visual capabilities:

- Wireless high-speed internet access with on-site technical support
- Large projection screen and projector
- Podium
- PC computer
- Connection for laptop computer
- Document Camera
- PTZ camera with recording capabilities
- Full theatre audio system
- Lectern microphone
- 3 lavalier and 3 HandHeld microphones



**CONFERENCE AND
EVENT SERVICES**

780.471.8409 | 10210 Princess Elizabeth Ave NW, Edmonton, AB, T5G 0Y2
events@nait.ca | nait.ca/PlanAnEvent

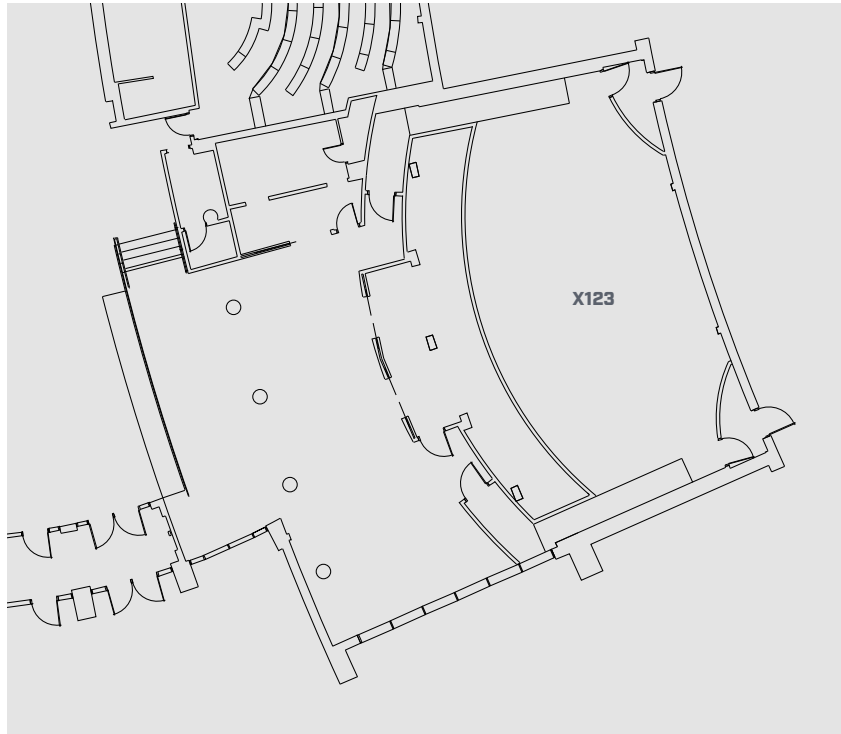

**CONFERENCE AND
EVENT SERVICES**

780.471.8409 | 10210 Princess Elizabeth Ave NW, Edmonton, AB, T5G 0Y2
events@nait.ca | nait.ca/PlanAnEvent